

Panasonic[®]

Operating Instructions

Home Network System Access Keypad

Model No. **KX-HNK101FX**



Thank you for purchasing a Panasonic product.

This document explains how to operate the access keypad properly. For details about how to use the system, refer to the User's Guide (page 16).

Please read this document before using the unit and save it for future reference.

Table of Contents

Introduction

Accessory information3

Important Information

About this system4

For your safety4

Important safety instructions5

For best performance5

Other information6

Setup

Part names and functions8

Touchpanel buttons8

LED indicator9

Setup overview9

Registering the keypad9

Confirming the usage area10

Installation11

Appendix

Using the keypad16

Features available when using the
[Home Network] app16

Accessing the User's Guide16

Specifications17

Accessory information

Supplied accessories

No.	Accessory item/Part number	Quantity
①	AC adaptor/PNLV226CE	1
②	Mounting bracket*1	1
③	Wall mounting screws (25 mm)	2
④	Wall anchors	2

*1 The mounting bracket is attached to the product at the time of shipment.

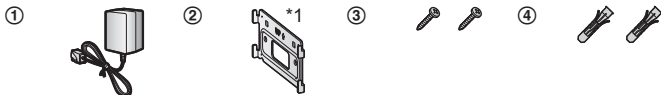

Other information

- Design and specifications are subject to change without notice.
- The illustrations in these instructions may vary slightly from the actual product.

Trademarks

- iPhone and iPad are trademarks of Apple Inc., registered in the U.S. and other countries.
- Android is a trademark of Google Inc.
- Microsoft, Windows, and Internet Explorer are either registered trademarks or trademarks of Microsoft Corporation in the United States and/or other countries.
- All other trademarks identified herein are the property of their respective owners.

About this system

- This system is an auxiliary system; it is not designed to provide complete protection from property loss. Panasonic will not be held responsible in the event that property loss occurs while this system is in operation.
- The system's wireless features are subject to interference, therefore functionality in all situations cannot be guaranteed. Panasonic will not be held responsible for injury or damage to property that occurs in the event of wireless communication error or failure.

For your safety

To prevent severe injury and loss of life/property, read this section carefully before using the product to ensure proper and safe operation of your product.



WARNING

Power connection

- Use only the power source marked on the product.
- Do not overload power outlets and extension cords. This can result in the risk of fire or electric shock.
- Completely insert the AC adaptor/power plug into the power outlet. Failure to do so may cause electric shock and/or excessive heat resulting in a fire.
- Regularly remove any dust, etc. from the AC adaptor/power plug by pulling it from the power outlet, then

wiping with a dry cloth. Accumulated dust may cause an insulation defect from moisture, etc. resulting in a fire.

- Unplug the product from power outlets if it emits smoke, an abnormal smell, or makes an unusual noise. These conditions can cause fire or electric shock. Confirm that smoke has stopped emitting and contact an authorised service centre.
- Unplug from power outlets and never touch the inside of the product if its casing has been broken open. Danger of electric shock exists.
- Never touch the plug with wet hands. Danger of electric shock exists.
- Do not connect non-specified devices.

Installation

- To prevent the risk of fire or electrical shock, do not expose the product to rain or any type of moisture.
- Do not place or use this product near automatically controlled devices such as automatic doors and fire alarms. Radio waves emitted from this product may cause such devices to malfunction resulting in an accident.
- Do not allow the AC adaptor to be excessively pulled, bent or placed under heavy objects.
- Keep small parts (screws, etc.) out of the reach of children. There is a risk of swallowing. In the event they are swallowed, seek medical advice immediately.

Operating safeguards

- Unplug the product from power outlets before cleaning. Do not use liquid or aerosol cleaners.
- Do not disassemble the product.
- Never put metal objects inside the product. If metal objects enter the product, turn off the circuit breaker and contact an authorised service centre.

Medical

- Consult the manufacturer of any personal medical devices, such as pacemakers or hearing aids, to determine if they are adequately shielded from external RF (radio frequency) energy. DECT features operate between 1.88 GHz and 1.90 GHz with a peak transmission power of 250 mW.
- Do not use the product in health care facilities if any regulations posted in the area instruct you not to do so. Hospitals or health care facilities may be using equipment that could be sensitive to external RF energy.

CAUTION

Installation and location

- Never install wiring during a lightning storm.
- The AC adaptor is used as the main disconnect device. Ensure that the AC outlet is installed near the product and is easily accessible.

Important safety instructions

When using your product, basic safety precautions should always be followed to reduce the risk of fire, electric shock, and injury to persons, including the following:

1. Do not use this product near water for example, near a bathtub, washbowl, kitchen sink, or laundry tub, in a wet basement or near a swimming pool.
2. Use only the power cord indicated in this document.

SAVE THESE INSTRUCTIONS

For best performance

Hub location/avoiding noise

The hub and other compatible Panasonic devices use radio waves to communicate with each other.

- For maximum coverage and noise-free communications, place your hub:
 - at a convenient, high, and central location with no obstructions between the product and hub in an indoor environment.
 - away from electronic appliances such as TVs, radios, personal computers, wireless devices, or other phones.
 - facing away from radio frequency transmitters, such as external antennas of mobile phone cell stations. (Avoid putting the hub on a bay window or near a window.)

Important Information

- If the reception for a hub location is not satisfactory, move the hub to another location for better reception.

Environment

- Keep the product away from electrical noise generating devices, such as fluorescent lamps and motors.
- The product should be kept free from excessive smoke, dust, high temperature, and vibration.
- The product should not be exposed to direct sunlight.
- Do not place heavy objects on top of the product.
- When you leave the product unused for a long period of time, unplug the product from the power outlet.
- The product should be kept away from heat sources such as radiators, cookers, etc. It should not be placed in rooms where the temperature is less than 0 °C or greater than 40 °C. Damp basements should also be avoided.
- Operating the product near electrical appliances may cause interference. Move away from the electrical appliances.

Other information

Routine care

- Wipe the outer surface of the product with a soft moist cloth.
- Remove any dirt from the touchpanel by wiping it with a soft, dry cloth. When wiping the touchpanel, use your fingers to gently hold it in place, taking care not to scratch it with your fingernails.

- Do not use any cleaning products that contain alcohol, polish powder, powder soap, benzene, thinner, wax, petroleum, or boiling water. Also do not spray the product with insecticide, glass cleaner, or hair spray. This may cause a change in colour or quality of the product.

Disposal of Old Equipment (Only for European Union and countries with recycling systems)



This symbol on the products, packaging, and/or accompanying documents means that used electrical and electronic products must not be mixed with general household waste. For proper treatment, recovery and recycling of old products, please take them to applicable collection points in accordance with your national legislation.

By disposing of them correctly, you will help to save valuable resources and prevent any potential negative effects on human health and the environment. For more information about collection and recycling, please contact your local municipality.

Penalties may be applicable for incorrect disposal of this waste, in accordance with national legislation.

For business users in the European Union

If you wish to discard electrical and electronic equipment, please contact

your dealer or supplier for further information.

Information on Disposal in other Countries outside the European Union

This symbol is only valid in the European Union. If you wish to discard these items, please contact your local authorities or dealer and ask for the correct method of disposal.

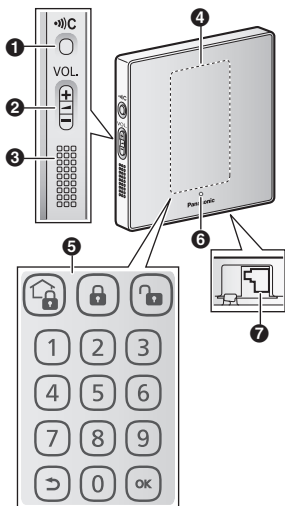

Part names and functions



- 1** **[•••)C]**
Used when registering the keypad to the hub.
- 2** **Volume**
Used to adjust the volume of the sounds emitted by the keypad.
- 3** **Speaker**
- 4** **Touchpanel**
When no buttons are displayed here, touch this area to display the buttons.
- 5** **Touchpanel buttons**
- 6** **LED indicator**
- 7** **DC jack**

Touchpanel buttons

These buttons allow you to confirm and change the system's arm mode. During normal operation, the button that corresponds to the current arm mode is lit by default, and all other buttons are dimmed. When you tap the touchpanel, the arm mode buttons light for 10 seconds. During this time, you can tap an arm mode button to switch to the corresponding arm mode.

Button	Status
None displayed	No power, or buttons are turned off ¹ .
 , lit	Normal operation, [Arm: At Home] mode is selected.
 , lit	Normal operation, [Arm: Away] mode is selected.
 , lit	Normal operation, [Disarm] mode is selected.
Current arm mode button blinking slowly	Alarm system was triggered.
All buttons blinking slowly	Registration mode (you pressed and held [•••)C])

- *1 You can configure the keypad so that its arm mode buttons do not light during normal operation. For more information, refer to the User's Guide (page 16).

LED indicator

You can use the LED indicator to confirm the keypad's status.

Indicator	Status
Off	Normal operation, or no power
Red, blinking slowly	Keypad is not registered to a hub.
Red, blinking	Keypad is out of range of the hub.
Red, blinking quickly	Alarm system was triggered.
Green, blinking slowly	Registration mode (You pressed and held [••)C])

Setup overview

- 1 Initial setup**
Make sure you can access the system using your mobile device. For details, refer to the System Setup Guide included with your hub.
- 2 Registration**
Required only if the keypad was purchased separately (i.e., not as part of a bundle).
- 3 Confirm the installation area**
Read the information in this document to confirm that the desired installation area is suitable for proper operation.
- 4 Installation**
Install the keypad in the desired location.

Registering the keypad

This procedure is not required for devices that were included as part of a bundle.

Before you can use the keypad, it must be registered to the hub.

If you purchased devices separately (i.e., not as part of a bundle), you must register each device to the hub.

You can register each device by using the registration buttons or the **[Home Network]** app.

Note:

- Before registering the keypad, make sure the AC adaptors of the hub and keypad are connected and each device is powered.

Using registration buttons

- 1 Hub:**
Press and hold **[••)C OTHER DEVICE]** until the LED indicator blinks slowly in green.
- 2 Keypad:**
Press and hold **[••)C]** until the LED indicator starts blinking slowly in green and the touchpanel buttons start blinking slowly.
 - When registration is complete, the hub sounds one long beep.

Note:

- To cancel without registering the keypad, press **[••)C]** on the hub and on the keypad again.
- If registration fails, the hub sounds several short beeps.

Using the app

When you register the keypad by using the **[Home Network]** app, you can assign a name to your devices and group them by location. For more information, refer to the User's Guide (page 16).

Confirming the usage area

Wireless communication range

The wireless communication range of each device in the system from the hub is approximately 50 m indoors and approximately 300 m outdoors.

Wireless communication may be unreliable when the following obstacles are located between the hub and other devices.

- Metal doors or screens
- Walls containing aluminum-sheet insulation
- Walls made of concrete or corrugated iron
- Double-pane glass windows
- Multiple walls
- When using each device on separate floors or in different buildings

Note:

- The keypad's LED indicator blinks in red if it is out of range of the hub. In this case, confirm all connections, including those of the hub.

Usage area cautions

Using the keypad in the following areas may cause deformation, malfunction, or operational failure.

- In direct sunlight
- Areas exposed to grease or steam, such as kitchens
- Near fire or heating devices
- Near magnetic fields (such as near microwaves and magnets)
- Areas subject to extreme temperature changes, such as next to air conditioners
- Areas with reflective objects, such as glass, that can interfere with detection of temperature variation
- Areas where the temperature is affected by strong illuminating objects (such as fluorescent lights)
- Near devices that emit strong radio waves, such as mobile phones

Installation

To mount the keypad flat against the wall, use the mounting bracket.

Note:

- Mount the keypad on the stable location where the keypad can be adequately supported when mounting.
- Do not mount keypad on a soft material. It may fall down, break, or cause injury.
- Do not mount the keypad on a plywood surface that is less than 25.4 mm thick.
- The pull-out strength of the installation area must be at least 29.4 N (3 kgf).

Determining the installation location

Note:

- Make sure there is at least 20 cm of space to the left of the keypad (when mounted) so that the buttons on the side of the keypad can be accessed.
- 1 Remove the mounting bracket.
 - Place the keypad face-down on a flat surface, slide the bracket toward the bottom of the keypad (1) by pushing it with your thumbs as shown (2), and then lift the bracket up and away from the keypad (3).

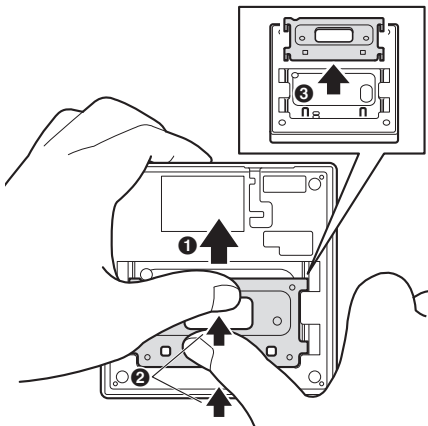

Setup

- 2 Place the mounting bracket against the wall and determine where the mounting bracket will be installed. Mark the screw openings on the wall.
- Refer to the information below. The dotted lines indicate where the edges of the keypad will be in relation to the mounting bracket.

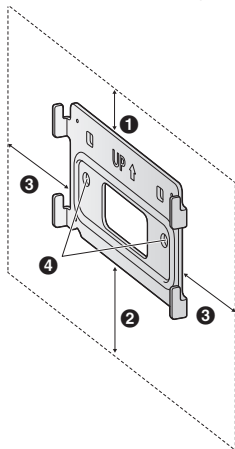

- ❶ 16 mm
- ❷ 59 mm
- ❸ 19 mm
- ❹ Screw openings
60 mm apart

- 3 Drill pilot holes where you marked the screw openings in the previous step.
- The screw openings must be 60 mm apart.

Installing the mounting bracket

Installing the mounting bracket on wooden walls

Line up the holes on the mounting bracket with the holes in the wall, then insert and tighten each screw.

Note:

- Use the supplied screws (A).
- Place the bracket with the “UP” mark facing upwards.

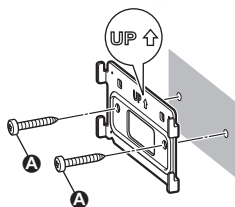

Installing the mounting bracket on gypsum board, ALC (autoclaved lightweight cellular concrete), or concrete blocks

Use the supplied anchors and screws to mount the mounting bracket to the wall.

Note:

- Supplied anchors \varnothing : 5 mm \times 25 mm.
- Supplied screws \varnothing : 4 mm \times 25 mm.

- 1 Mark the hole depth (A) on the drill bit at 35 mm and then drill the hole.
 - Use a 4.8 mm drill bit.

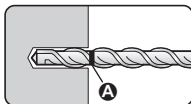

- 2 Remove debris.

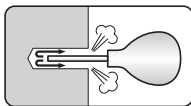

Setup

- 3 Insert the anchor into the hole so that it is flush with the wall surface.

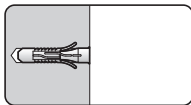

- 4 Line up the holes on the mounting bracket with the anchors, then insert and tighten each screw.

- Use the supplied screws (B).
- Place the bracket with the “UP” mark facing upwards.

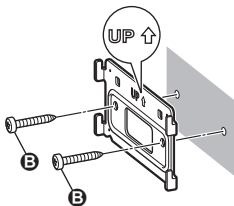

Installing the keypad to the mounting bracket

Attach the keypad to the bracket.

- Insert the grooves on the keypad to the 4 tabs on the bracket, and then push down the keypad.

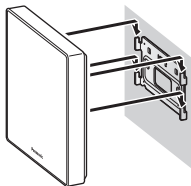

Connecting the AC adaptor

Note:

- Use only the supplied Panasonic AC adaptor PNLV226CE.

Connect the AC adaptor plug to the keypad until you hear a click (①) and connect the AC adaptor to the power outlet (②).

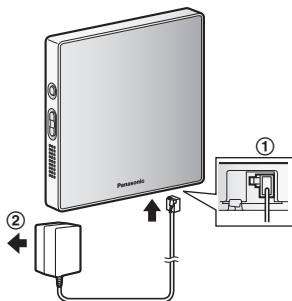

Note about power connections

AC adaptor connection

- The AC adaptor must remain connected at all times. (It is normal for the adaptor to feel warm during use.)
- The AC adaptor should be connected to a vertically oriented or floor-mounted AC outlet. Do not connect the AC adaptor to a ceiling-mounted AC outlet, as the weight of the adaptor may cause it to become disconnected.

Power failure

- The keypad will not work during a power failure.

Using the keypad

Changing the arm mode

- 1 Tap the touchpanel to light the arm mode buttons.
- 2 Tap the button of the desired arm mode.
 - If you tap  to disarm the alarm system, enter the disarm PIN (default: "0000") and then tap **[OK]**.

Note:

- We recommend changing the PIN from the default before operating the alarm system. For more information, refer to the User's Guide (page 16).
- When the arm mode is changed with the keypad, the arm mode icons displayed on the app will not be automatically changed. The displayed arm mode icons will be updated when the app refreshes the home screen.

Confirming the arm mode

By default, the button corresponding to the current arm mode is lit during normal operation. If the **[Home Network]** app was used to change this setting, the button does not light.

Cancelling a trigger

When the alarm system is triggered, the keypad sounds an alert and the current arm mode button blinks slowly. Use the following procedure to stop the alert.

To cancel the trigger, tap the touchpanel, enter the disarm PIN (default: "0000"), and then tap **[OK]**.

Talking notification feature

This feature allows you to get information about a triggered sensor. When a sensor is triggered, the keypad can announce the location of the sensor detected, the sensor name, and the type of detection. For more information, refer to the User's Guide (page 16).

Features available when using the **[Home Network]** app

Some of the keypad's features that are available when using the **[Home Network]** app are listed below. For more information, refer to the User's Guide (page 16).

– Alarm system

You can use the app to arm and disarm the alarm system.

– Device management

You can use the app to change the keypad's name, select whether or not the arm mode buttons are displayed, and turn voice guidance and key tones on and off.

Accessing the User's Guide

The User's Guide is a collection of online documentation that helps you get the most out of the **[Home Network]** app.

1 iPhone/iPad

Tap  in the app's home screen.

Android™ devices

Tap  or press your mobile device's menu button in the app's home screen.

2 Tap [User's Guide].**Note:**

- Microsoft® Windows® Internet Explorer® 8 and earlier versions are not supported.
- Android 4.1 or later versions are recommended.
- You can also access the User's Guide at the web page listed below.



www.panasonic.net/pcc/support/tel/homenetwork/manual/

Specifications

- **Standards**
DECT (Digital Enhanced Cordless Telecommunications)
- **Frequency range**
1.88 GHz – 1.90 GHz
- **RF transmission power**
Approx.: 10 mW (average power per channel)
250 mW (max.)
- **Power source**
220 – 240 V AC, 50/60 Hz
- **Power consumption**
Standby: Approx. 0.6 W
Maximum: Approx. 2.0 W
- **Operating conditions**
0 °C – 40 °C

- **Dimensions (height × width × depth)**

Approx. 120 mm × 120 mm × 21 mm

- **Mass (weight)**

Approx. 163 g (without the mounting bracket attached)

For your future reference

We recommend keeping a record of the following information to assist with any repair under warranty.

Serial No.	Date of purchase
(found on the rear of the unit)	
Name and address of dealer	

Attach your purchase receipt here.

Panasonic Corporation

1006, Oaza Kadoma, Kadoma-shi, Osaka 571-8501, Japan

<http://www.panasonic.com>

© Panasonic Corporation 2016