

Quick Reference Guide

Parts Descriptions

その他

Quick Reference Guide

VE-PVC11L Base Unit

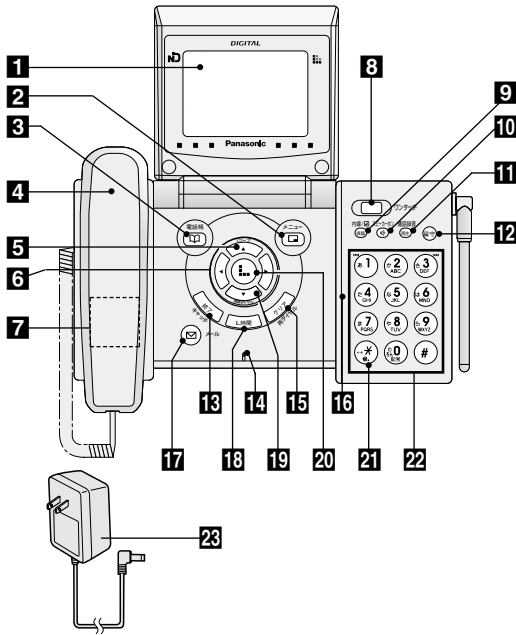

- 1** Angle-adjustable display
- 2** Menu key
- 3** Directory key
- 4** Handset
- 5** L warp key
- 6** L mode navigation keys
- 7** Speaker
- 8** One-touch key
- 9** Hold/Extension key
- 10** Hands-free key · lamp
- 11** Playback/Voice record key
- 12** Voice message key · lamp
- 13** Call waiting/Cancel key
- 14** Microphone
- 15** Re-dial/Clear key
- 16** L lamp
- 17** Mail key
- 18** L time key
- 19** Simple dial key
- 20** L key
- 21** Asterisk key (to switch to DTMF tone)
- 22** Numeral/Character keys
- 23** AC adaptor for VE-PVC11L

VE-PS109N Personal Phone

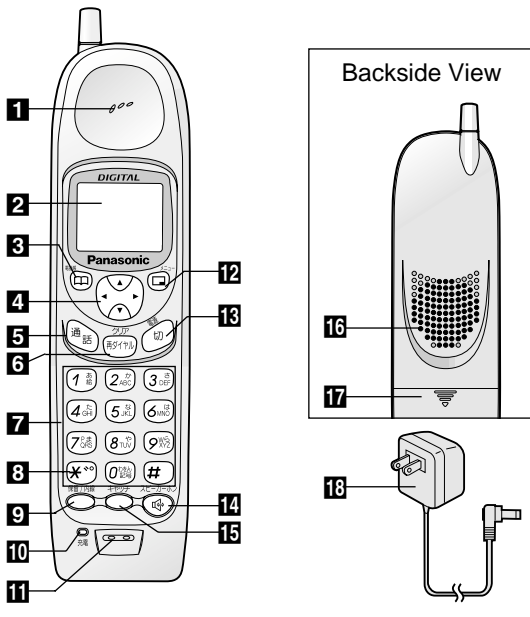

- 1** Earpiece
- 2** Display
- 3** Directory key
- 4** Navigation keys
- 5** Send/Answer key · lamp
- 6** Re-dial/Clear key
- 7** Numeral/Character keys · lamps
- 8** Asterisk key (to switch to DTMF tone)
- 9** Hold/Extension key
- 10** Battery charging indicator
- 11** Microphone
- 12** Menu key
- 13** Power/End key
- 14** Hands-free key · lamp
- 15** Call waiting key
- 16** Speaker
- 17** Battery cover
- 18** AC adaptor for VE-PS109N

注) 日本国内専用です。電圧、電話交換方式、電波法などの異なる海外では使用できません。

CAUTION: These telephones are for use in Japan only. They cannot be used in other countries because of differences in voltages, telephone switching system and radio regulation laws.

Basic Operations

Base unit (VE-PVC11L)



*To make a call

Lift the handset. → Dial.

*To receive a call

When the phone rings... → Lift the handset.

*To make a call using the speakerphone (Hands-free talk)

Dial. → Press **スピーカホン** (10 Hands-free key).

→ Talk to the microphone..... To end the call, press **スピーカホン** (10 Hands-free key).

*To receive a call using the speakerphone (Hands-free talk)

When the phone rings... → Press **スピーカホン** (10 Hands-free key).

→ Talk to the microphone..... To end the call, press **スピーカホン** (10 Hands-free key).

*To place the current call on hold

Press **保留** (9) during a call.

*To retrieve the held call

■ During a call through your handset, press **保留** (9) again.
If you have returned the handset on the base unit, lift the handset.

■ During Hands-free talk, press **スピーカホン** (10 Hands-free key).

*To transfer the held call to the personal phone

Press **保留** (9) during a call. → Press **2** (Extention No.).

(If you transfer to the extention No.3, press **3**)

→ Place the handset on the base unit when the other party answers.

*To set a calendar

With the handset placed on the base unit, press **メニュー** **2** **0**

→ Enter the year. → Enter the month in 2 digits and date in 2 digits (Press **0** **1** **0** **1** for January 1st, for example). → Enter the time in 4 digits. (Press **2** **3** **3** **0** for 11:30 P.M., for example). → Press **メニュー** (**2**) .

*To use TAM (Telephone Answering Machine)

Set the calendar beforehand.

When you leave home, press **留守** (**12**) to turn on the lamp.

(To deactivate, press **留守** again to turn off the lamp.)

→ When receiving a call while TAM is activated, it answers the call automatically in Japanese, and records the incoming messages.

Then, the **留守** lamp starts flashing. → When you return home, press **留守** to play back the messages.

The **留守** lamp turns off and the answering mode is deactivated.

To play back the message while TAM is deactivated, press **再生** (**11** Playback key).

*Up to 59 messages can be recorded for 10 minutes in total.

*To hear recorded messages while away from home (Remote control)

Preparation before you leave home

Store a remote control number.

With the handset placed on the base unit, press **メニュー** **2** **1**

→ Enter the desired 4-digit number. → Press **メニュー** .

When you leave home, press **留守** to turn on the lamp.

To hear messages

Dial your home phone number. → While the outgoing message is played back... → Enter your remote control number.

→ Announcement → Press **2** . → You will hear recorded messages if any.

NOTE

- This operation can be made only from telephones which can send touch-tone signals.



Personal phone (VE-PS109N)

*To turn the power on

Press and hold **電源** (**18**) for longer than one second.

*To make a call

Lift the personal phone from the charger or press **通話** (**5**) .

→ Dial.

To end the call, place the personal phone on the charger or press **切** (**18**) .

*To receive a call

When the phone rings... → Lift the personal phone from the charger or press **通話** . → Talk.

To end the call, place the personal phone on the charger or press **切** .

*To make a call using the speakerphone (Hands-free talk)

Lift the personal phone from the charger and press **通話** . →

Dial. → Press **スピーカ** (**14**) . → Talk to the microphone.

To end the call, place the personal phone on the charger or press **切** .

*To receive a call with the speakerphone (Hands-free talk)

When the phone rings... → Press **スピーカ** or **通話** .

→ Talk to the microphone.

To end the call, press **切** .

*To place the current call on hold

Press **保留** (**9** Hold key) during a call.

*To retrieve the held call

Press **通話** .

*To transfer the held call to the base unit

Press **保留** (**9** Hold key) during a call. → Press **1** .

→ Place the personal phone on the charger, or press **切** when the other party answers.

*To set a calendar

Lift the personal phone from the charger and press **切** . → Press

メニュー **0** **9** . → Enter the year. → Enter the month in 2 digits

and date in 2 digits (Press **0** **1** **0** **1** for January 1st,

for example). → Enter the time in 4 digits (Press **2** **3** **3** **0**

for 11:30 P.M., for example). → Press **メニュー** (**12**).