

Installation and Operation Guide

Door Station

Model No. **VL-V522L**



Thank you for purchasing a Panasonic product.

- Please read this guide before using the unit and save for future reference.
- Please read this guide carefully, and install the unit safely and correctly by following the instructions. Panasonic assumes no responsibility for injuries or property damage resulting from failures arising out of improper installation or operation inconsistent with this guide.
- In this guide, the suffix of each model number (e.g., the "BX" in "VL-V522L BX") is omitted unless necessary.

For your safety

To prevent severe injury and loss of life/property, read this section carefully before using the unit to ensure proper and safe operation of your unit.

WARNING

- To reduce the risk of electric shock, do not disassemble this unit. Refer servicing to an authorized service center when service is required. Opening or removing covers may expose you to dangerous voltages or other risks. Incorrect reassembly can cause electric shock when the unit is subsequently used.
- Never install wiring during a lightning storm.
- When existing chime wires are used, it is possible that they contain AC voltage. Electric shock or unit damage could result. Contact an authorized service center.

CAUTION

- Install the unit securely adhering to the instructions in this guide to prevent it from falling off the wall. Avoid installing onto low-strength walls, such as gypsum board, ALC (autoclaved lightweight concrete), concrete block, or veneer (less than 18 mm thick) walls.
- If the wiring is underground, do not make any connections underground.
- If the wiring is underground, use a protection tube.

Included accessories

- Wood screws2 (3.8 mm x 20 mm)
- Attached to the bag the door station is in.

Specifications

Power source:	Supplied by the main monitor station
Dimensions:	Approx. height 131 mm x width 99 mm x depth 36.5 mm (Excluding protruding sections)
Mass (Weight):	Approx. 200 g
Operating environment:	-15 °C to 55 °C, Up to 90 % RH (Relative Humidity) non condensing Wall mount (Wall mount base included)
Installation method:	LED lights
Lighting method:	Minimum illuminance required: 1 lx (within Approx. 50 cm from the camera lens)
Minimum illuminance required:	Viewing angle: Horizontally: Approx. 87° Vertically: Approx. 66°
Viewing angle:	

Note:

- Design and specifications are subject to change without notice.
- The pictures and illustrations in these instructions may vary slightly from the actual product.

Panasonic System Networks Co., Ltd.
1-62, 4-chome, Minoshima, Hakata-ku, Fukuoka 812-8531, Japan
<http://www.panasonic.com>

© Panasonic System Networks Co., Ltd. 2015



PNQW4842ZA C0915NS0

Location of controls

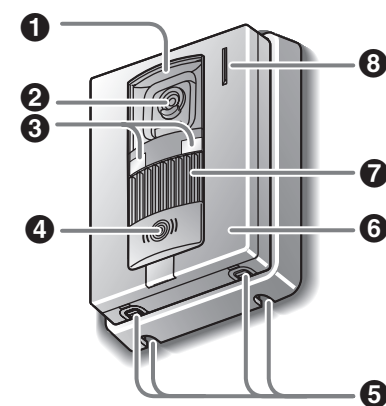

- 1 Lens cover
- 2 Camera
- 3 LED lights (for illumination)
- 4 [CALL] button and indicator
 - The indicator is lighted with a red LED while the power is on.
 - When a visitor presses the call button, a ringer tone will ring.
- 5 Water drain holes
- 6 Panel
- 7 Speaker
- 8 Microphone

Door station image quality

- The following phenomena may occur. They are not malfunctions.
- If the sun can be seen, its center appears as a black dot.
 - At night or when there is poor lighting in the doorway, the image colors become unclear. If there is a light in the doorway, the image may appear greenish. When the door station's LED lights are off, the image of the subject may be displayed in black and white (or bluish-purple).
 - During the daytime or if there is bright light in the doorway, the color of the visitor's clothing may appear differently to the actual color.

Cleaning

Clean the unit with a soft, dry cloth when cleaning. For excessive dirt, wipe the unit with a slightly damp cloth.

Important:

- Do not use anything containing alcohol, polish powder, powder soap, benzine, thinner, wax, petroleum, or boiling water. Also do not spray with insecticide, glass cleaner, or hair spray. This could cause a change in color or quality.

Important information

Disposal of Old Equipment (Only for European Union and countries with recycling systems)



This symbol (1) on the products, packaging, and/or accompanying documents means that used electrical and electronic products must not be mixed with general household waste.

For proper treatment, recovery and recycling of old products, please take them to applicable collection points in accordance with your national legislation. By disposing of them correctly, you will help to save valuable resources and prevent any potential negative effects on human health and the environment. For more information about collection and recycling, please contact your local municipality. Penalties may be applicable for incorrect disposal of this waste, in accordance with national legislation.

Information on Disposal in other Countries outside the European Union

Above symbol (1) is only valid in the European Union. If you wish to discard this product, please contact your local authorities or dealer and ask for the correct method of disposal.

For Europe

For detailed information about the Declaration of Conformity, refer to the documentation provided with the main monitor station used with door station. We declare under our sole responsibility that the product to which this declaration relates is in conformity with the standard or other normative document following the provisions of Directive 2004/108/EC.

Ecodesign information

Ecodesign information under EU Regulation (EC) No. 1275/2008 amended by (EU) Regulation No. 801/2013. From 1 January 2015. Please visit here: www.ptc.panasonic.eu
Click [Downloads]
→ Energy related products information (Public)
Power consumption in networked standby and guidance are mentioned in the web site above.

Authorised Representative in EU:



Panasonic Testing Centre
Panasonic Marketing Europe GmbH
Winsbergring 15, 22525 Hamburg, Germany

Before installation

To avoid malfunction or communication disturbances, do not install the door station in the following locations:

- Places where vibration or any other kind of impact occurs.
- Places near hydrogen sulfide.

Installation position of the door station and camera range

Views when the camera is facing forwards at 0° (default).

- Example: Installation height is 1450 mm (standard position).

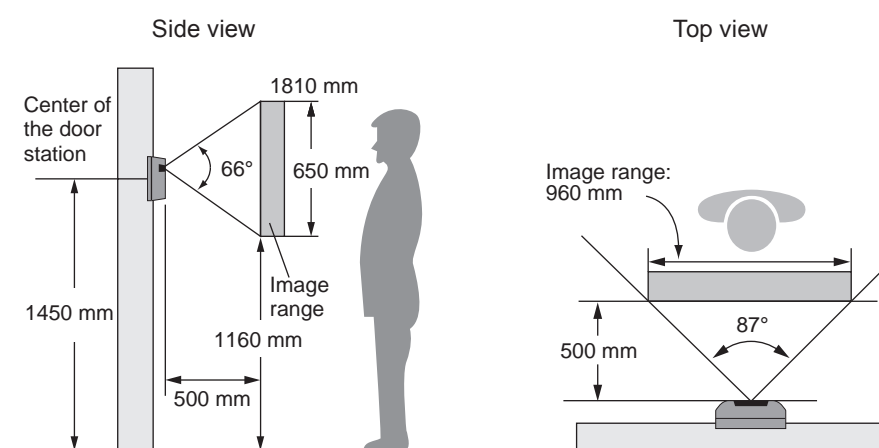

The camera angle can be adjusted using the camera angle control lever on the rear of the door station (step 3, "Installing the door station"), so that the image range can be changed.

Side view when the camera is installed lower than the standard position, and facing upwards at 15°.

- Example: Installation height is 1100 mm.

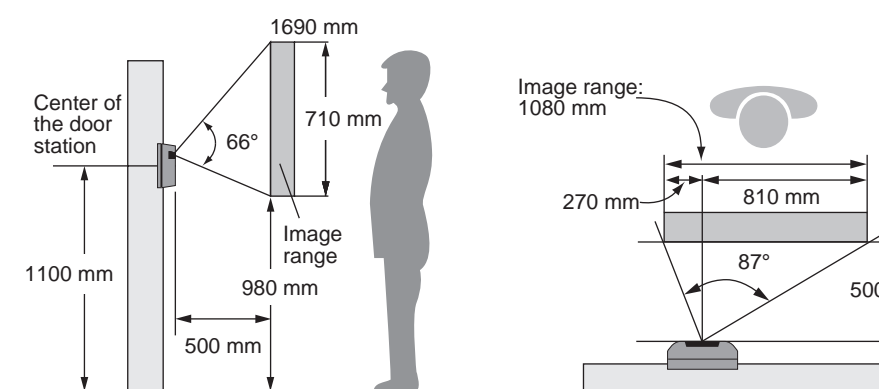

*1 If the camera points 15° upwards, the left or right angle is less than 7°.

Note:

- The measurements and angles are for reference purposes and may vary depending on the environment.
- If a strong light is shining on the door station, the visitor's face may not be distinguishable. Do not place the door station in the following locations.
 - Where most of the background is the sky.
 - Where the background is a white wall, and direct sunlight will reflect off it.
 - Where direct sunlight will shine on the door station.
- Do not place the door station in the locations where echoing occurs, causing the unit to beep frequently.
- Make sure the rear of the door station is not subject to water.

Wire type and distance

• Wire (between the main monitor station and the door station):

Type	Distance	Loop resistance
General cable CAT-3	Maximum 50 m	10 Ω or lower
General cable 22 AWG (ø 0.65)	Maximum 100 m	

Installing the door station

Important:

- On the bottom surface of the door station, there are holes to allow water to drain. Do not cover them up when installing.

1 Remove the mounting base.

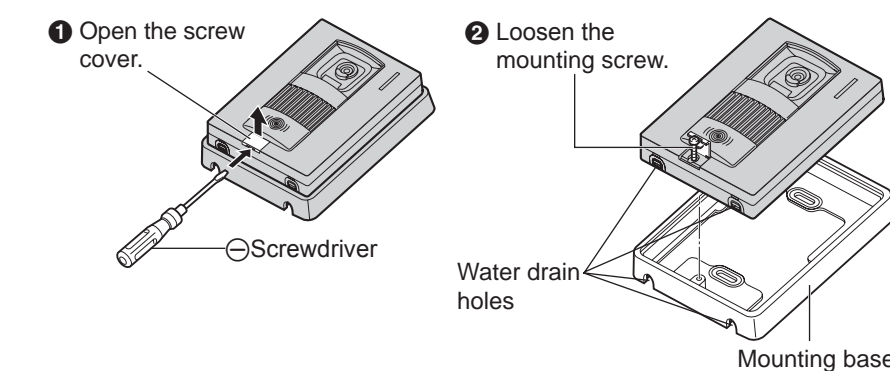

2 Attach the mounting base to the wall securely using the wood screws (3.8 mm x 20 mm).

- Install the mounting base on a vertical flat wall.
- Before drilling, refer to "Before installation" for installation location.

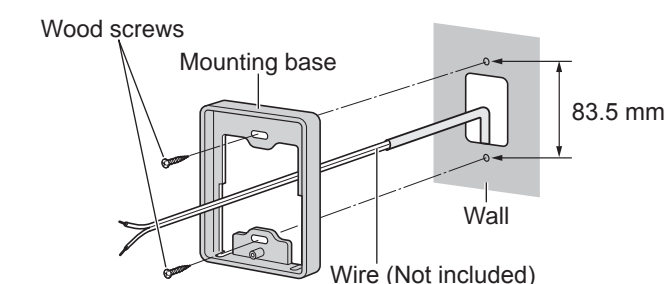

3 Adjust the camera angle using the camera angle control lever.

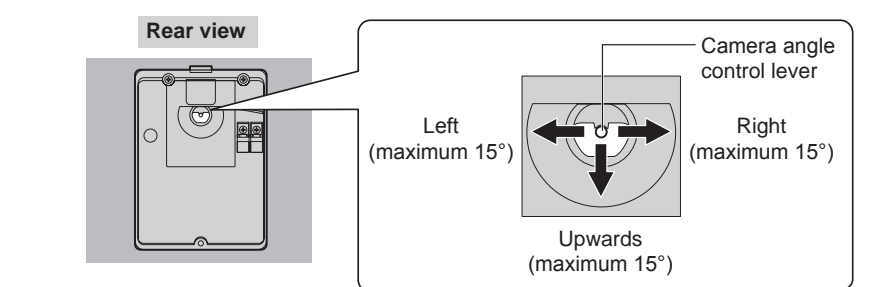

<Examples of camera angle>

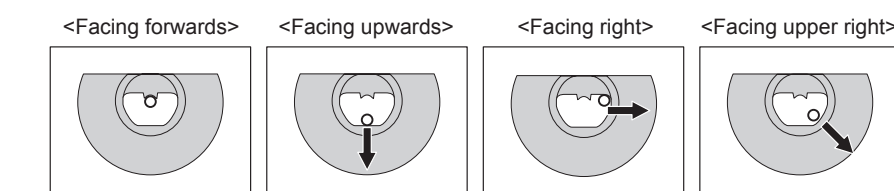

- The angle can also be adjusted to the left or upper left.

Important:

- When the camera angle is adjusted to the upper left or upper right, the image may be slightly distorted.

4 Connect the wire, then mount the door station to the mounting base.

